

DTE

the choice of millions of dentists worldwide

Guilin Woodpecker Medical Instrument Co., Ltd.
Information Industrial Park, Guilin National High-Tech
Zone, Guilin, Guangxi, 541004 P.R. China
Sales Dept.: +86-773-5873196
E-mail: woodpecker@glwoodpecker.com
Website: http://www.glwoodpecker.com

Scan and log on to website
for more information

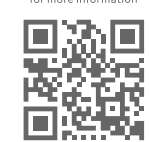

Find us on



Find us on



Find us on



Find us on



DTE

Ai-surgery

The Latest Generation Piezo Bone Surgery



SC Series

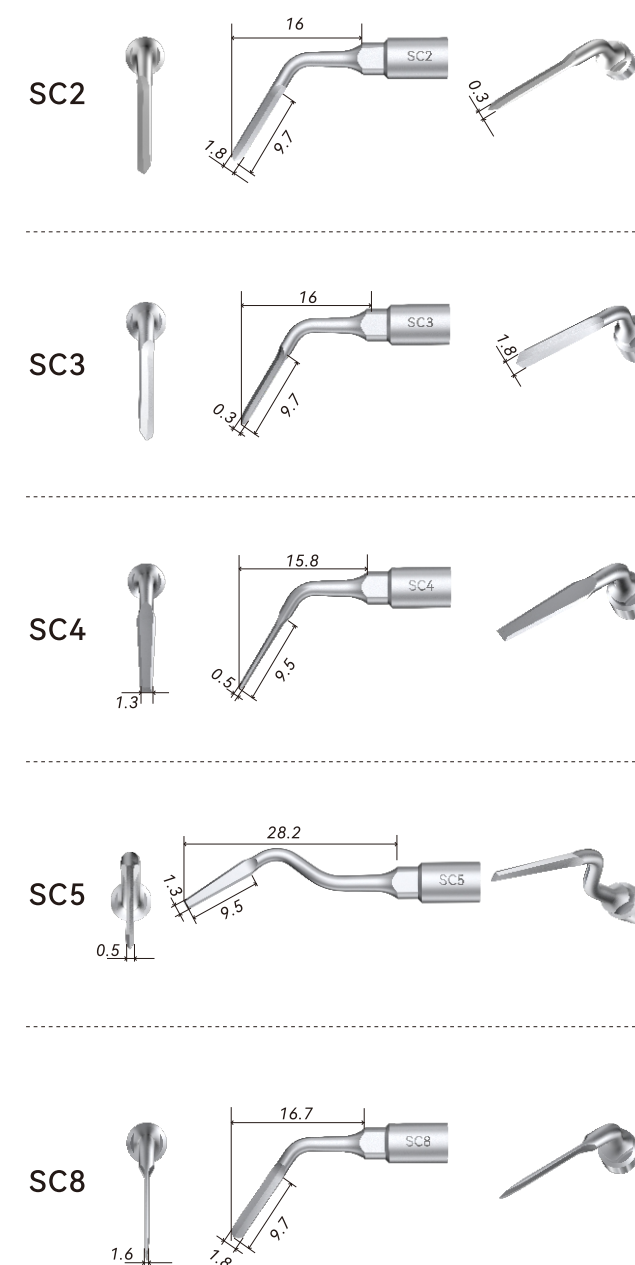

SE Series

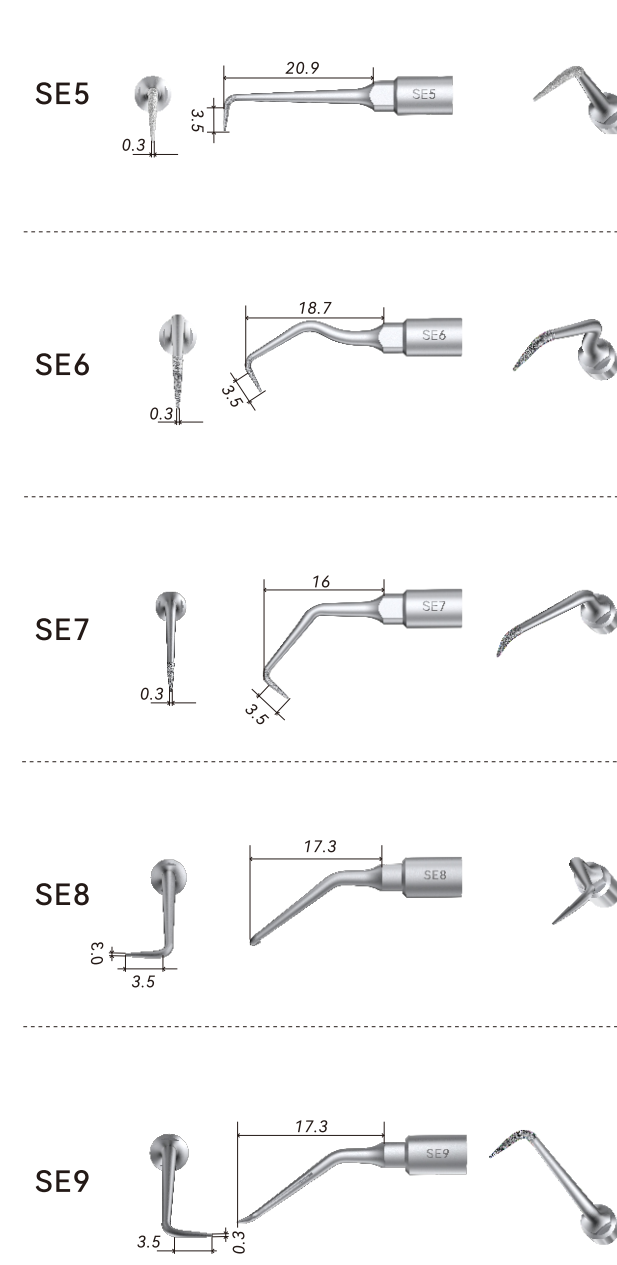

SL Series

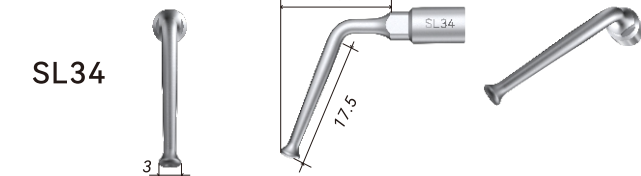
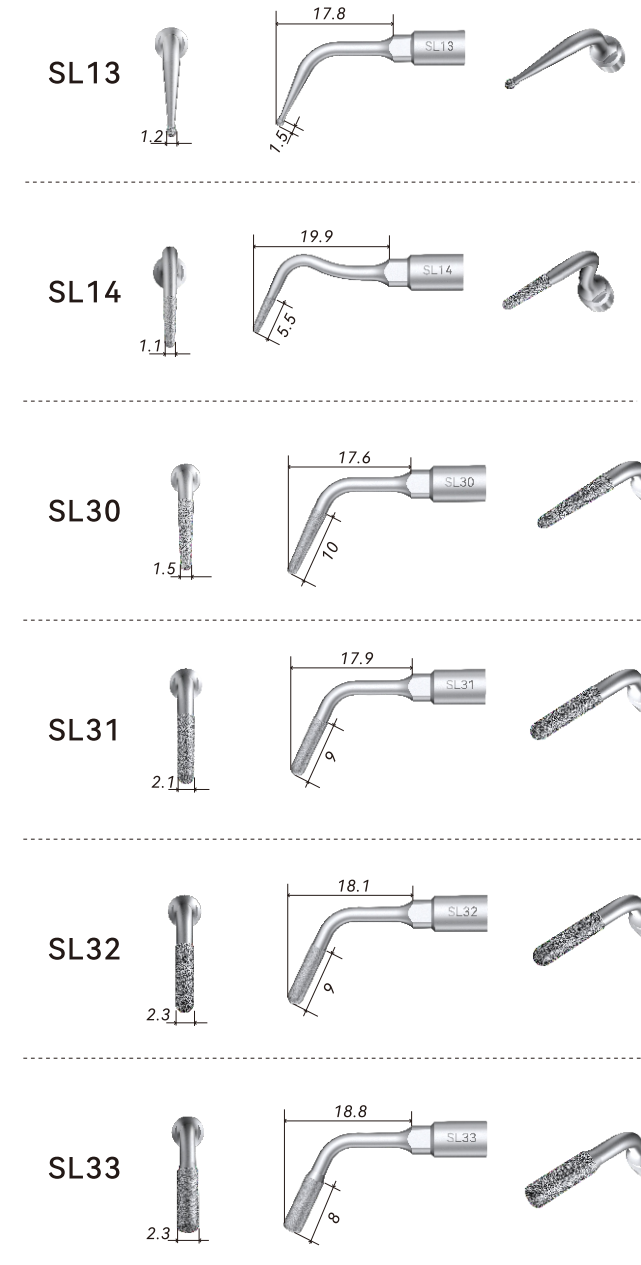

SP Series

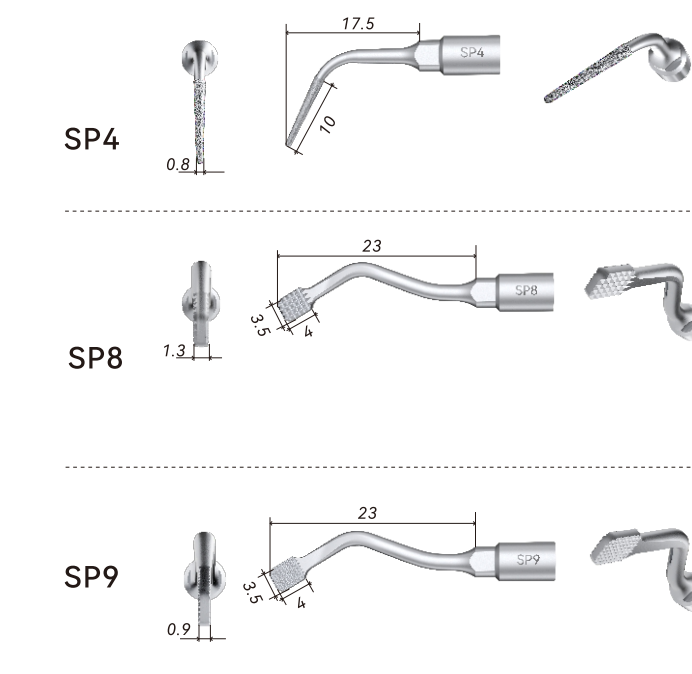

SS Series

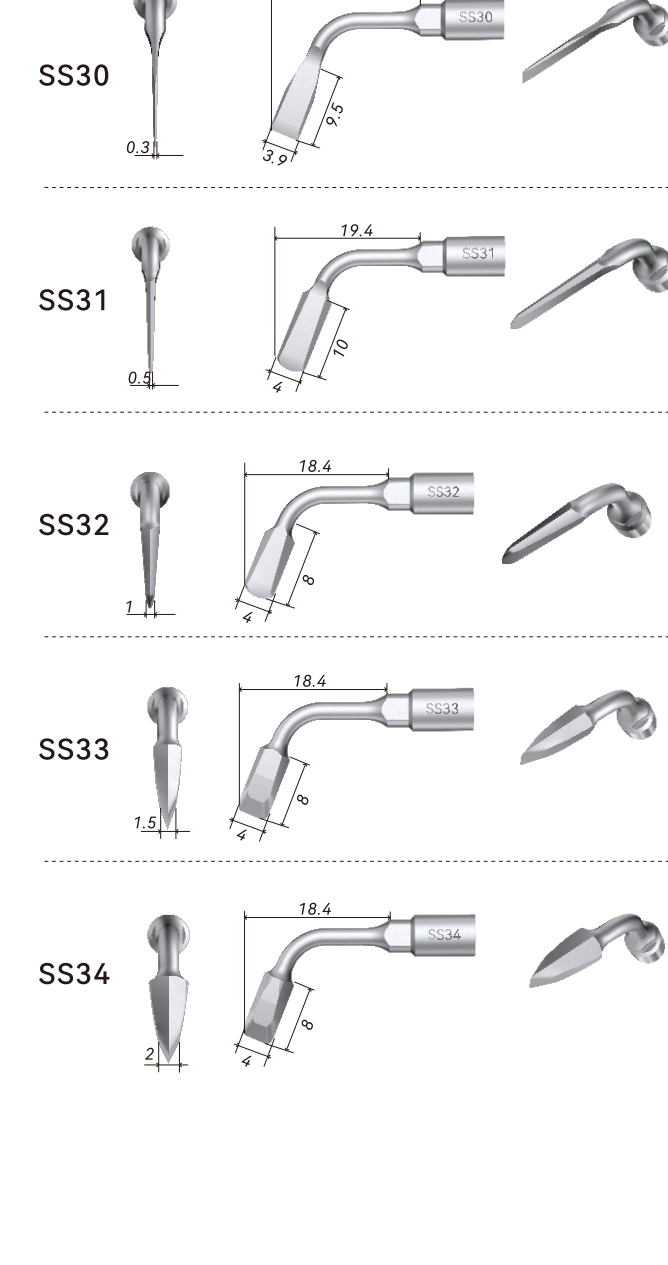
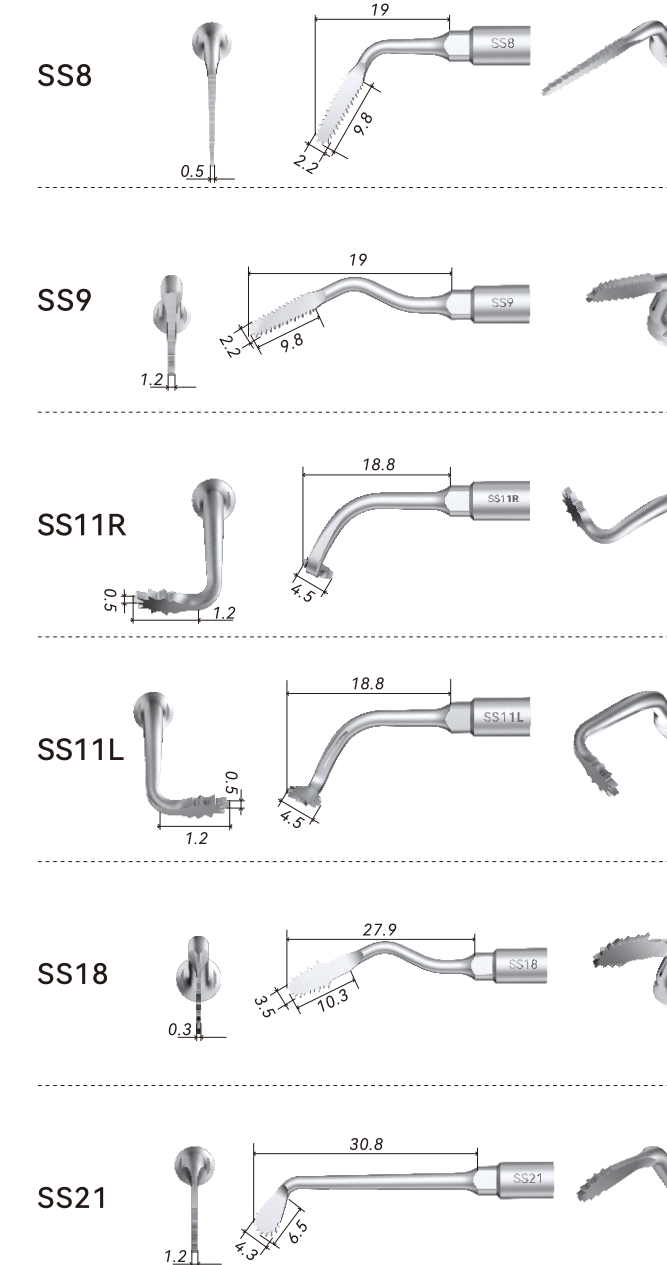

INTELLIGENT AND POWERFUL



Product with the latest technology from
WOODPECKER, providing dentists with a superbly
reliable and safe ultrasonic surgical system

NEWLY UPGRADED

Efficient

Woodpecker fourth generation of Piezo Bone Surgery, with greatly improved cutting
efficiency than the third generation

Intelligent

The intelligent system will automatically adjust to the most appropriate output
power according to the operation situation to avoid overheating

User-friendly

New operation interface, more convenient for doctors to use



Basic kits

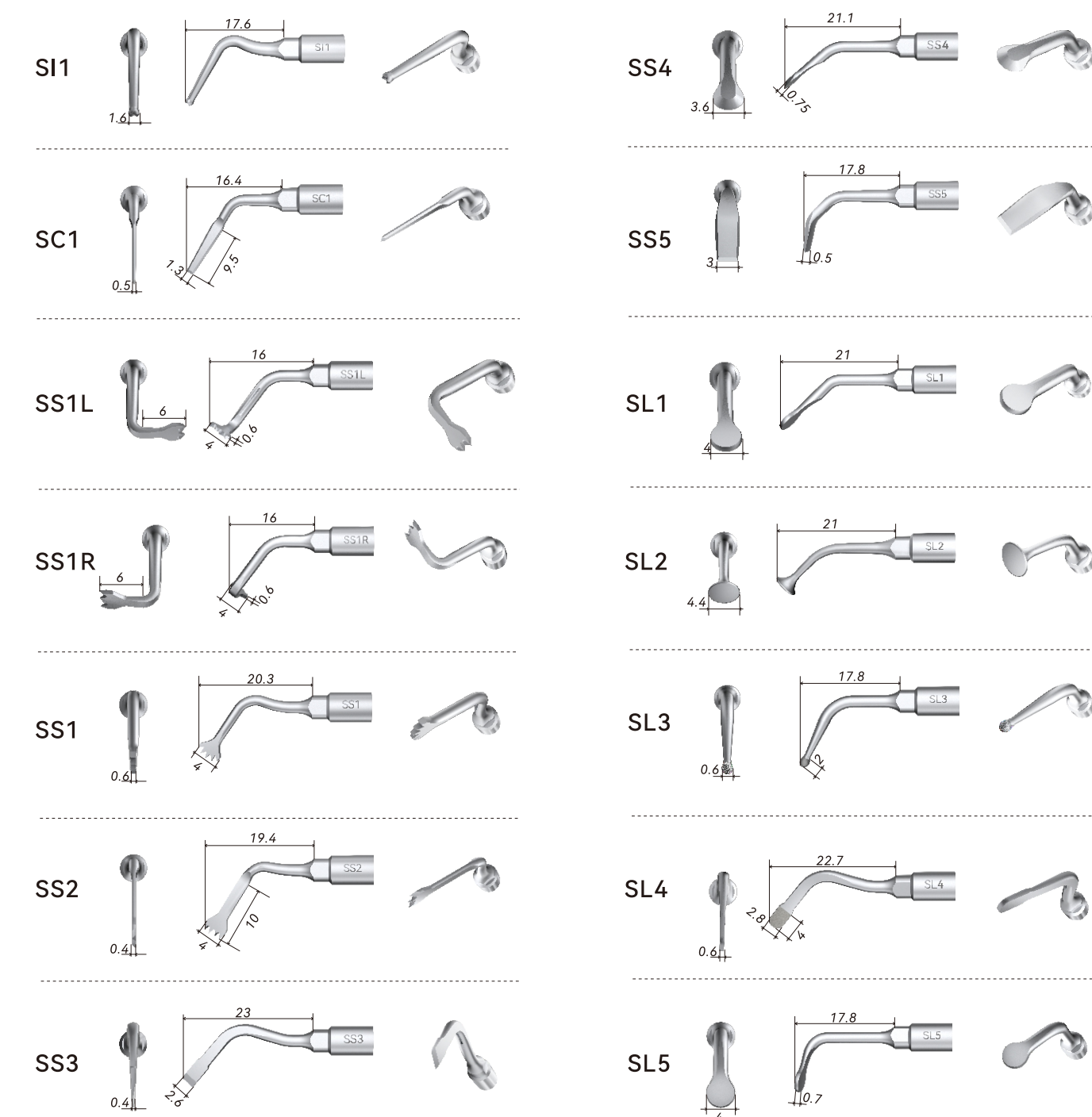

STRONG POWER

Strong power, no handpiece
overheating, thanks to:

- New enhanced handpiece
- Advanced sensing technology
- Smart control system

Smart control system

- Automatic identification of different bone quality and strength
to perform power adjustment, achieving the optimal output
- Easy and effort-saving for doctors
- Less noise at work



EXTREMELY RELIABLE

Convenient operation

Fully upgraded Woodpecker fourth generation of Piezo Bone Surgery, easier to operate

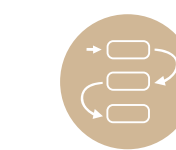

Mode selection

Power varies as per different bone quality



Water flow adjustment

Different water flow adjustment levels
to choose from



One-touch enhancement

Exclusively featured one-touch power
enhancement



Easy rinse

After each use, rinse the pipeline via
control of foot pedal



Multi-function foot pedal

- Control of multiple functions
- One-button rinse mode



Sterilizable water pipe

- External handpiece for easy disassembly and maintenance
- Autoclavable

Ultra-quiet peristaltic pump

- Continuous and precise flow control; direct water
flow to the tip end; efficient cooling
- More silent and stable